

# **A12 Chelmsford to A120 widening scheme**

**TR010060**

## **2.9 GENERAL ARRANGEMENT PLANS**

**PART 4**

APFP Regulation 5(2)(o)

Planning Act 2008

Infrastructure Planning (Applications: Prescribed  
Forms and Procedure) Regulations 2009

Volume 2

June 2023

## Infrastructure Planning

### Planning Act 2008

# A12 Chelmsford to A120 widening scheme

## Development Consent Order 202[ ]

---

### GENERAL ARRANGEMENT PLANS PART 4

---

<b>Regulation Number:</b>	Regulation 5(2)(o)
<b>Planning Inspectorate Scheme Reference</b>	TR010060
<b>Application Document Reference</b>	TR010060/APP/2.9
<b>Author:</b>	A12 Project Team, National Highways

<b>Version</b>	<b>Date</b>	<b>Status of Version</b>
P03	June 2023	DCO Change

# LEGEND

## BOUNDARIES

- ORDER LIMITS
- ORDER LIMITS EXCLUSION ZONE
- ADMINISTRATIVE BOUNDARY

## HIGHWAYS

- NEW OR REALIGNED PUBLIC HIGHWAY/ ROAD
- NEW OR REALIGNED MAINTENANCE ACCESS / PRIVATE MEANS OF ACCESS
- EXISTING PUBLIC RIGHT OF WAY
- EXISTING CYCLE TRACK
- EXISTING PUBLIC RIGHT OF WAY - STOPPED UP
- NEW FOOTPATH / BRIDLEWAY
- PROPOSED CYCLE TRACK
- PROPOSED FOOTWAY
- NEW PERMISSIVE PATH
- PROPOSED CONTROLLED CROSSING
- PROPOSED UNCONTROLLED CROSSING
- PROPOSED TECHNOLOGY GANTRY (CANTILEVER)
- PROPOSED TECHNOLOGY GANTRY
- PROPOSED GANTRY MOUNTED DIRECTION SIGN
- PROPOSED LIGHTING COLUMN

## ENGINEERING & CONSTRUCTION

- PROPOSED CONSTANT CUTTING
- PROPOSED CONSTANT EMBANKMENT
- PROPOSED MITIGATION EARTHWORKS
- PROPOSED MITIGATION EARTHWORKS (BORROW PITS)
- PROPOSED CARRIAGEWAY/ ROAD
- PROPOSED FOOTWAY / HARDSTANDING / ISLAND
- PROPOSED VERGE
- NEW OR MODIFIED BRIDGE DECK
- EXISTING BRIDGE DECK (TO BE RETAINED)
- EXISTING BRIDGE DECK (TO BE DEMOLISHED)
- PROPOSED RETAINING WALL
- EXISTING RETAINING WALL

## DRAINAGE

- EXISTING CULVERT (TO BE RETAINED)
- PROPOSED CULVERT - MINOR WATERCOURSE
- EXISTING CULVERT (TO BE EXTENDED)
- EXISTING CULVERT (TO BE ABANDONED)
- PROPOSED WATERCOURSE DIVERSION (MAIN RIVER)
- WATER FLOW DIRECTION
- PROPOSED CUT-OFF DITCH (FILTER DRAIN IN SPATIAL CONSTRAINT AREA)
- EXISTING DITCH / MINOR WATERCOURSE (TO BE RETAINED)
- EXISTING DITCH / MINOR WATERCOURSE (TO BE REALIGNED)
- EXISTING DITCH / MINOR WATERCOURSE (TO BE ABANDONED)
- PROPOSED ATTENUATION POND (WITH OUTFALL CONNECTION)
- PROPOSED UNDERGROUND STORAGE UNITS
- PROPOSED FLOOD MITIGATION AREA
- PROPOSED FLOOD BUND

## ENVIRONMENT

### EXISTING

- EXISTING OPEN WATER
- EXISTING TREES, HEDGES AND SHRUBS
- EXISTING ANCIENT WOODLAND
- EXISTING ANCIENT, NOBLE AND VETERAN TREES
- EXISTING CONSERVATION AREAS
- EXISTING LOCAL NATURE RESERVE
- EXISTING LISTED BUILDINGS
- EXISTING REGISTERED PARKS AND GARDENS
- EXISTING SCHEDULED MONUMENT
- EXISTING TREES PROTECTED BY TREE PRESERVATION ORDER (AREA OR INDIVIDUAL TREE)

### PROPOSED

- PROPOSED OPEN WATER
- PROPOSED WOODLAND PLANTING OF TREES AND SHRUBS
- PROPOSED WET WOODLAND
- PROPOSED TALL SCREEN PLANTING TO ELEVATE FLIGHT PATH OF BATS & BARN OWLS
- PROPOSED INDIVIDUAL TREES
- PROPOSED HEDGE
- PROPOSED HEDGE WITH INTERMITTENT TREES
- PROPOSED GRASSLAND
- PROPOSED INTERMITTENT TREES AND SHRUBS
- PROPOSED ECOLOGY POND (INDICATIVE)
- PROPOSED AQUATIC AND MARGINAL PLANTING (INDICATIVE)
- PROPOSED ECOLOGY MITIGATION AREA / ECOLOGY PROTECTION MEASURES
- PROPOSED NOISE BARRIER
- PROPOSED REPLACEMENT LAND

### NOTES

- THIS PLAN SHOULD BE READ IN CONJUNCTION WITH OTHER PLAN APPLICATION DOCUMENTS IN PARTICULAR SCHEDULE 3 OF THE DEVELOPMENT CONSENT ORDER.
- THIS LEGEND SHOULD BE READ IN CONJUNCTION WITH THE LOCATION KEY PLAN AND THE GENERAL ARRANGEMENT DRAWINGS.

Rev	Rev. Date	Purpose of revision	Drawn	Checked	Rev'd	Apprv'd
P01	01/08/2022	DCO APPLICATION	AE	CC	CA	DT
P02	30/09/22	DCO APPLICATION	ES	CA	RM	RM

Development Consent Order Number:	TR010060
Development Consent Order Drawing Number:	TR010060/APP/2.9



Project  
A12 CHELMSFORD TO A120 WIDENING SCHEME

Drawing title  
**GENERAL ARRANGEMENT  
PLANS  
LEGEND**

Regulation	REGULATION 5(2)(g)	
Purpose of issue	DCO APPLICATION	
State Code	Statutory Procedures and Powers	
Project Stage	PCF 4	Drawing status
Scale at A1 (841x594mm)	NTS	S4
Jacobs No.	B36601D1	Rev
Client no.	HE551497	P02

Drawing number	PIIN	Originator	Volume
HE551497 -	JAC	LDC -	
	SCHW	-DR- C	-0020

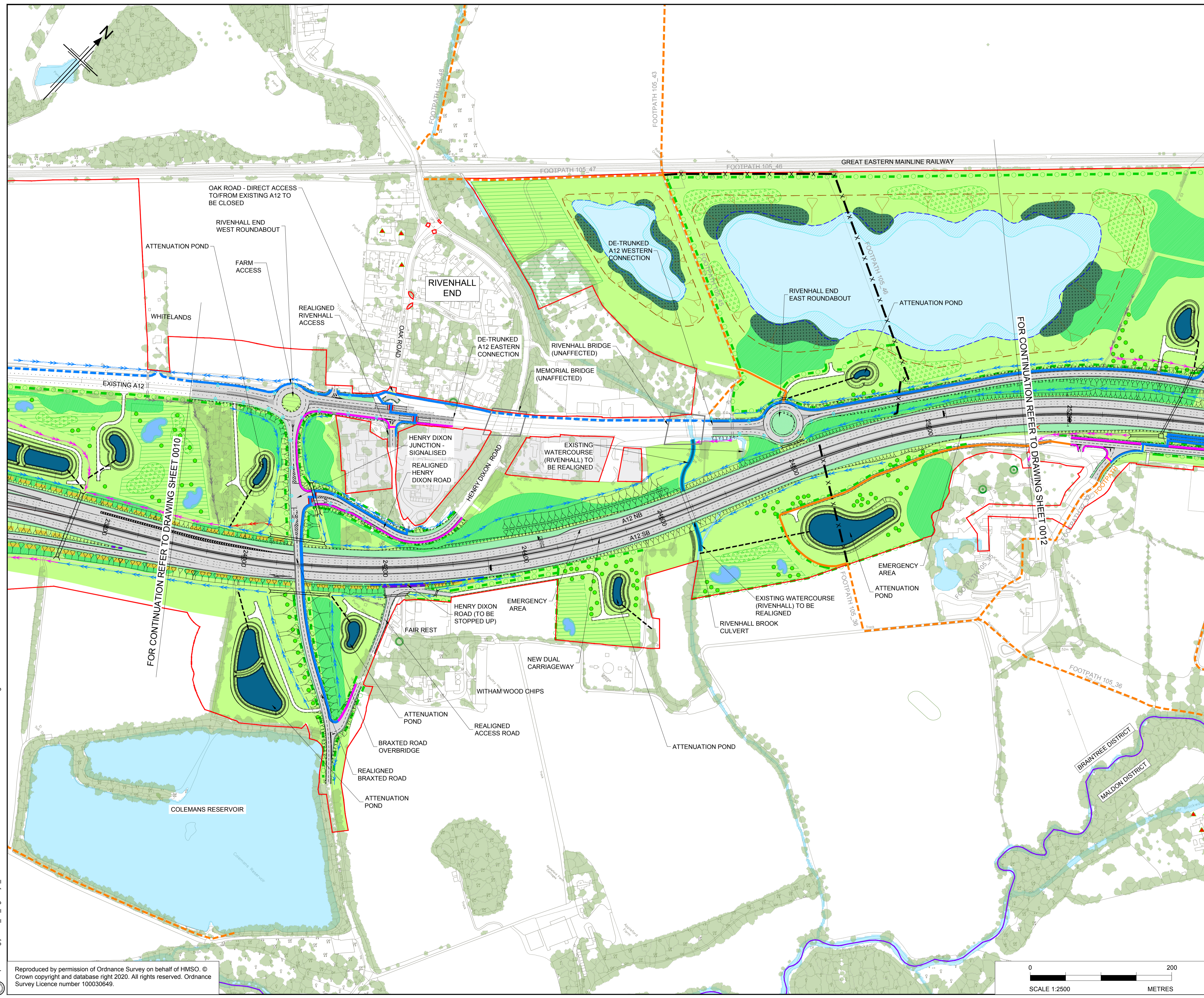

- NOTES
1. ALL DIMENSIONS ARE IN METRES UNLESS OTHERWISE STATED
  2. THIS PLAN SHOULD BE READ IN CONJUNCTION WITH THE GENERAL ARRANGEMENT PLANS, LEGEND AND OTHER APPLICATION DOCUMENTS IN PARTICULAR SCHEDULE 3 OF THE DEVELOPMENT CONSENT ORDER.
  3. THE BASE MAPPING IS BASED ON ORDNANCE SURVEY (O/S) DATA.

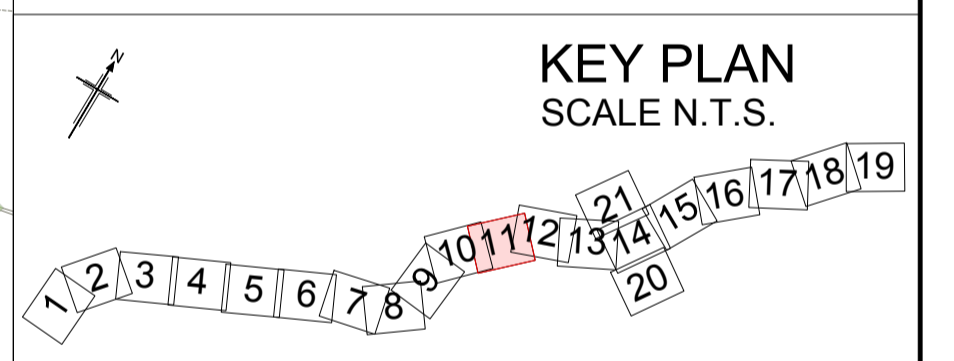

Rev	Rev. Date	Purpose of revision	Drawn	Checked	Rev'd	Appr'd
P01	01/08/22	FINAL FOR DCO SUBMISSION	AE	CC	CA	DT

Development Consent Order Number: TR010060  
 Development Consent Order Drawing Number: TR010060/APP/2.9



Project: A12 CHELMSFORD TO A120 WIDENING SCHEME

Drawing title: GENERAL ARRANGEMENT  
 CH. 23900 TO 25100  
 SHEET 11 OF 21

Regulation	REGULATION 5(2)(o)		
Purpose of issue	DCO APPLICATION		
State Code	Preliminary		
Project Stage	PCF 3	Drawing status	
Scale at A1 (841x594mm)	1:2500	S4	
Jacobs No.	B36601D1	Rev	
Client no.	HE551497	P01	

Drawing number: HE551497 - JAC - LDC - SCHW  
 PIN: -DR- C -0031  
 Originator: JAC  
 Volume: -DR- C -0031  
 Location: SCHW

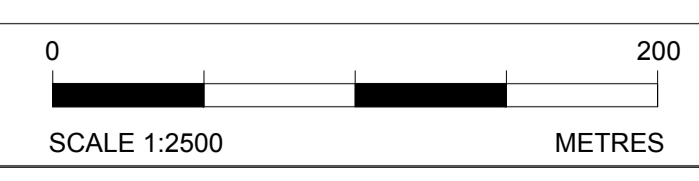

C:\working\jacobs\_uk\_highways\_ssa\enouram\0155451\HE551497\_JAC-LDC-SCHW-DR-C-0031.dwg - 03/08/2022 08:05:41 - A1Frame - EnourAM

Reproduced by permission of Ordnance Survey on behalf of HMSO. © Crown copyright and database right 2020. All rights reserved. Ordnance Survey Licence number 100030649.

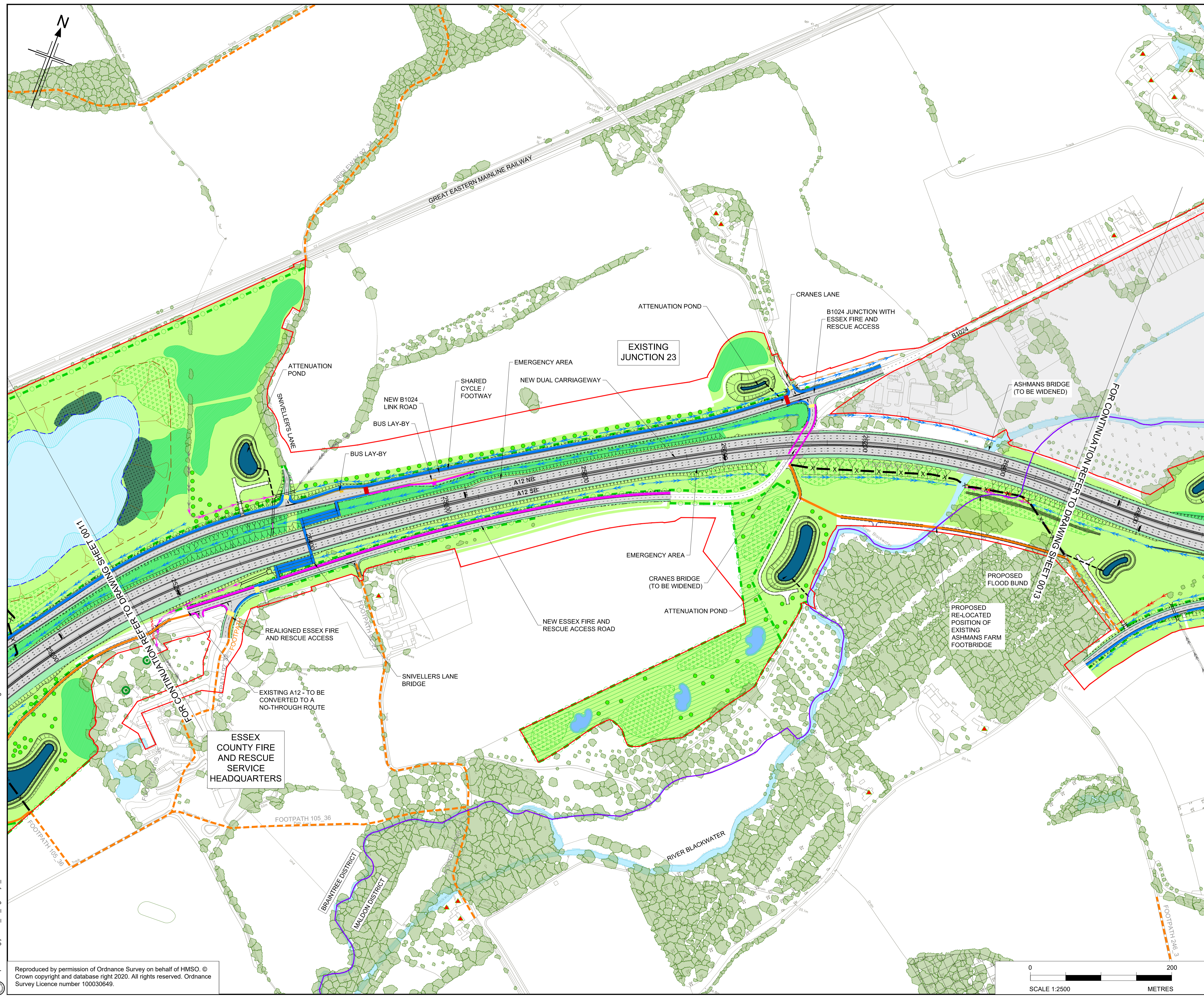

- NOTES**
1. ALL DIMENSIONS ARE IN METRES UNLESS OTHERWISE STATED
  2. THIS PLAN SHOULD BE READ IN CONJUNCTION WITH THE GENERAL ARRANGEMENT PLANS, LEGEND AND OTHER APPLICATION DOCUMENTS IN PARTICULAR SCHEDULE 3 OF THE DEVELOPMENT CONSENT ORDER.
  3. THE BASE MAPPING IS BASED ON ORDNANCE SURVEY (O/S) DATA.

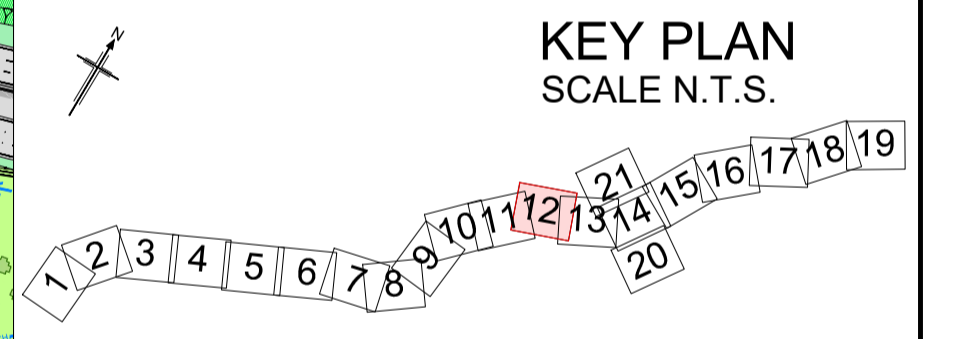

P01	01/08/22	FINAL FOR DCO SUBMISSION	AE	CC	CA	DT
P02	25/05/23	DCO CHANGE	AE	LH	RM	RM
Rev	Rev. Date	Purpose of revision	Drawn	Checked	Rev'd	Appr'd
Development Consent Order Number:			Development Consent Order Drawing Number:			
TR010060			TR010060/APP/2.9			



Project  
**A12 CHELMSFORD TO A120 WIDENING SCHEME**

Drawing title  
**GENERAL ARRANGEMENT  
CH. 25100 TO 26500  
SHEET 12 OF 21**

Regulation	REGULATION 8(1)(k)	
Purpose of issue	DCO EXAM	
State Code	Statutory Procedures and Powers	
Project Stage	PCF 4	Drawing status
Scale at A1 (841x594mm)	1:2500	S4
Jacobs No.	B36601D1	Rev
Client no.	HE551497	P02

Drawing number  
**HE551497 - JAC - LDC - SCHW - DR - C -0032**

C:\working\jacobs\_uk\_highways\_ssa\enoura\0155545\HE551497-JAC-LDC-SCHW-DR-C-0032.dwg - 25/05/2023 13:43:53 - A1Frame - Enoura

Reproduced by permission of Ordnance Survey on behalf of HMSO. © Crown copyright and database right 2020. All rights reserved. Ordnance Survey Licence number 100030649.

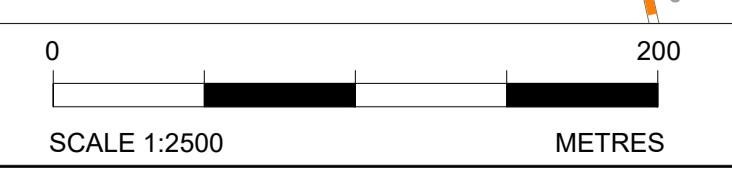



FOR CONTINUATION REFER TO DRAWING SHEET 0021

KELVEDON

ATTENUATION POND

FOOTPATH 92.15

ATTENUATION POND

ATTENUATION POND

EMERGENCY AREA

FOR CONTINUATION REFER TO DRAWING SHEET 0014

WIDENED DUAL CARRIAGEWAY

EMERGENCY AREA

HIGHFIELDS LANE

ATTENUATION POND

HIGHFIELDS BRIDGE (TO BE DEMOLISHED)

HIGHFIELDS OVERBRIDGE REPLACEMENT

REALIGNED BRAXTED ROAD

ATTENUATION POND

C:\working\jacobs\_uk\_highways\_ssa\enouram\01555451\HE551497\_JAC-LDC-SCHW-DR-C-0033.dwg - 03/08/2022 08:33:42 - A1Frame - EnourAM

Reproduced by permission of Ordnance Survey on behalf of HMSO. © Crown copyright and database right 2020. All rights reserved. Ordnance Survey Licence number 100030649.

- NOTES
1. ALL DIMENSIONS ARE IN METRES UNLESS OTHERWISE STATED.
  2. THIS PLAN SHOULD BE READ IN CONJUNCTION WITH THE GENERAL ARRANGEMENT PLANS, LEGEND AND OTHER APPLICATION DOCUMENTS IN PARTICULAR SCHEDULE 3 OF THE DEVELOPMENT CONSENT ORDER.
  3. THE BASE MAPPING IS BASED ON ORDNANCE SURVEY (O/S) DATA.

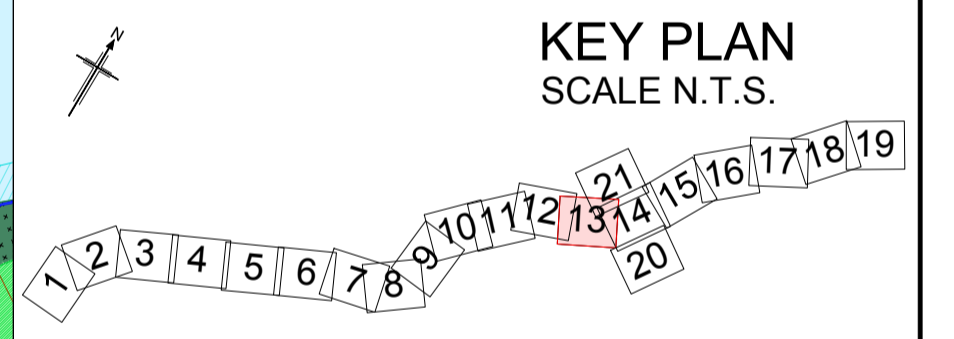

Rev	Rev. Date	Purpose of revision	Drawn	Checked	Rev'd	Appr'd
P01	01/08/22	FINAL FOR DCO SUBMISSION	AE	CC	CA	DT

Development Consent Order Number: TR010060  
Development Consent Order Drawing Number: TR010060/APP/2.9



Project  
A12 CHELMSFORD TO A120 WIDENING SCHEME

Drawing title  
**GENERAL ARRANGEMENT  
CH. 26500 TO 30700  
SHEET 13 OF 21**

Regulation	REGULATION 5(2)(o)		
Purpose of issue	DCO APPLICATION		
State Code	Preliminary		
Project Stage	PCF 3	Drawing status	S4
Scale at A1 (841x594mm)	1:2500	Rev	P01
Jacobs No.	B36601D1		
Client no.	HE551497		

Drawing number: HE551497 - JAC - LDC - SCHW  
Originator: JAC - LDC - SCHW  
Volume: -DR- C -0033



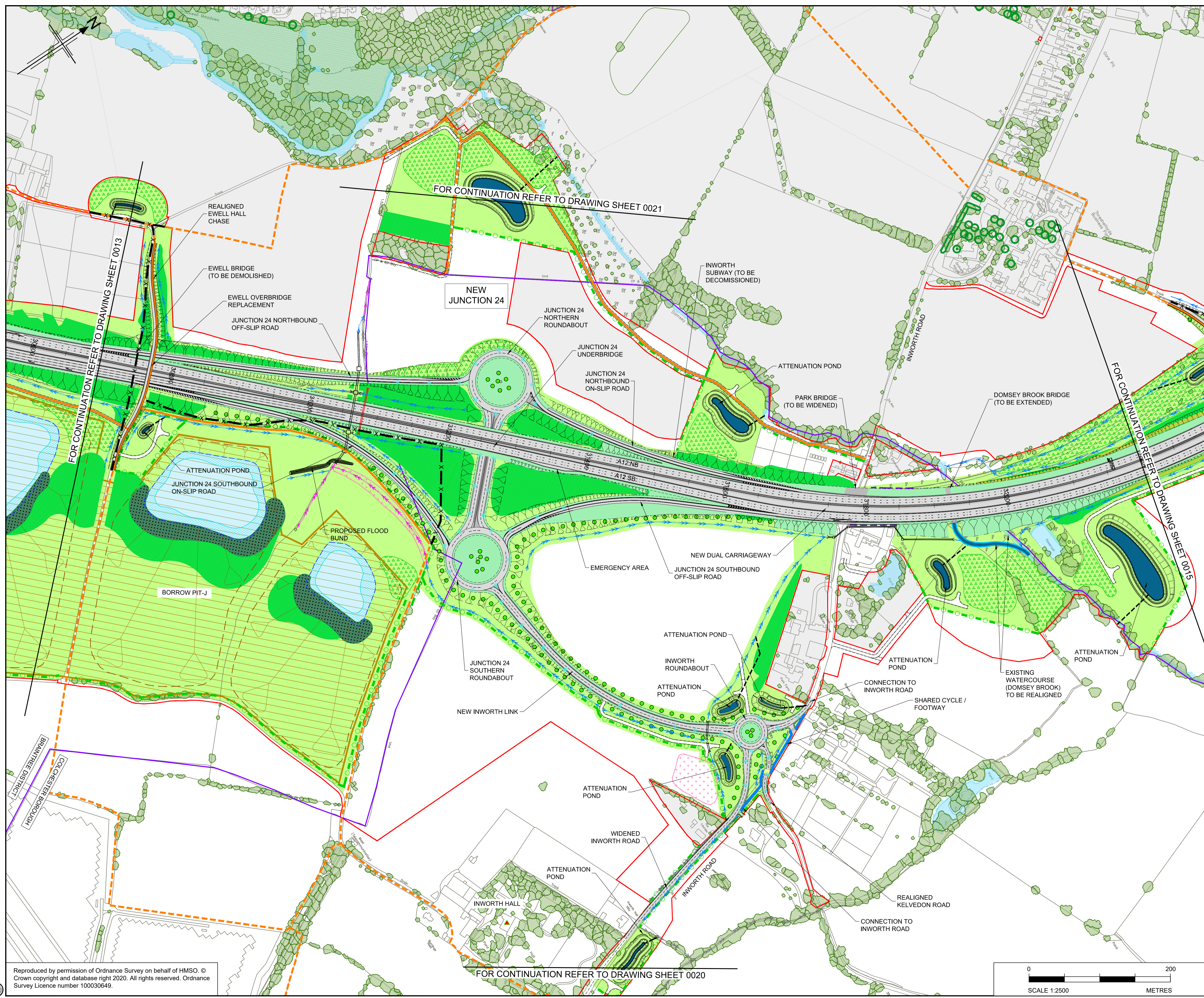

- NOTES
1. ALL DIMENSIONS ARE IN METRES UNLESS OTHERWISE STATED.
  2. THIS PLAN SHOULD BE READ IN CONJUNCTION WITH THE GENERAL ARRANGEMENT PLANS, LEGEND AND OTHER APPLICATION DOCUMENTS IN PARTICULAR SCHEDULE 3 OF THE DEVELOPMENT CONSENT ORDER.
  3. THE BASE MAPPING IS BASED ON ORDNANCE SURVEY (O/S) DATA.

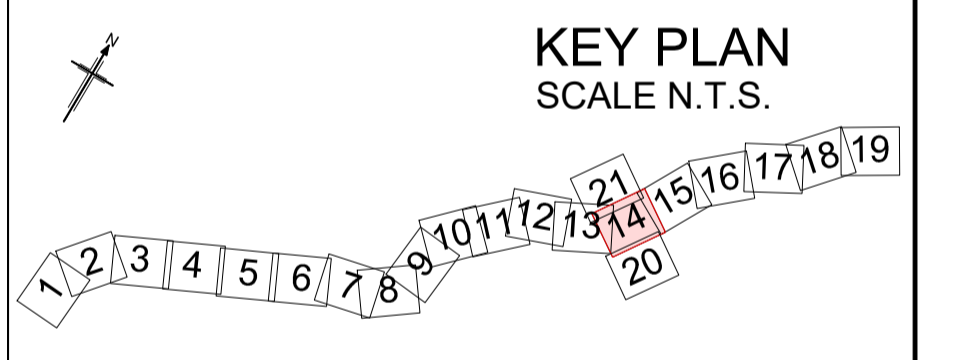

P01	02/08/22	FINAL FOR DCO SUBMISSION	AE	CC	CA	DT
P02	04/04/23	DCO CHANGE	MB	LH	RM	RM
P03	25/05/23	DCO CHANGE	AE	LH	RM	RM
Rev	Rev. Date	Purpose of revision	Drawn	Checked	Rev'd	Apprv'd

Development Consent Order Number: TR010060  
 Development Consent Order Drawing Number: TR010060/APP/2.9



Project: A12 CHELMSFORD TO A120 WIDENING SCHEME

Drawing title: **GENERAL ARRANGEMENT**  
**CH. 30700 TO 32200**  
**SHEET 14 OF 21**

Regulation	REGULATION 8(1)(k)		
Purpose of issue	DCO EXAM		
State Code	Statutory Procedures and Powers		
Project Stage	PCF 4	Drawing status	
Scale at A1 (841x594mm)	1:2500	S4	
Jacobs No.	B36601D1	Rev	
Client no.	HE551497	P03	

Drawing number: HE551497 - JAC - LDC - SCHW -DR- C -0034  
 PIN: | Originator: | Volume: | Location: | Type: | Role: | Number:

C:\pwworking\jacobson\_uk\_highways\_ssa\hawkins\155551497\JAC-LDC-SCHW-DR-C-0034.dwg - 25/05/2023 12:37:11 - A1Frame - hawkins

Reproduced by permission of Ordnance Survey on behalf of HMSO. © Crown copyright and database right 2020. All rights reserved. Ordnance Survey Licence number 100030649.

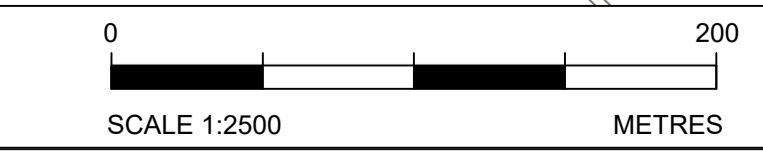

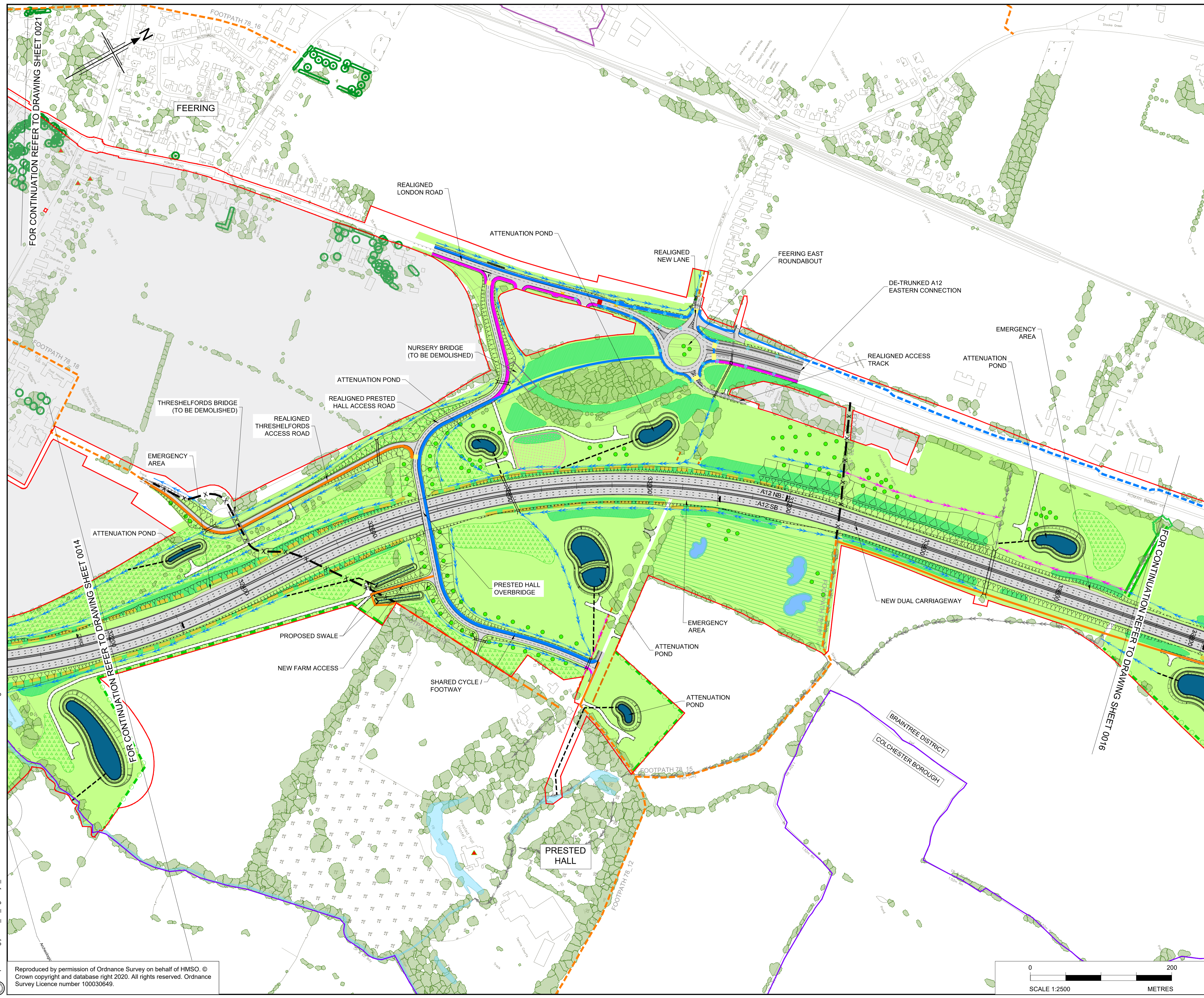

- NOTES**
1. ALL DIMENSIONS ARE IN METRES UNLESS OTHERWISE STATED
  2. THIS PLAN SHOULD BE READ IN CONJUNCTION WITH THE GENERAL ARRANGEMENT PLANS, LEGEND AND OTHER APPLICATION DOCUMENTS IN PARTICULAR SCHEDULE 3 OF THE DEVELOPMENT CONSENT ORDER.
  3. THE BASE MAPPING IS BASED ON ORDNANCE SURVEY (O/S) DATA.

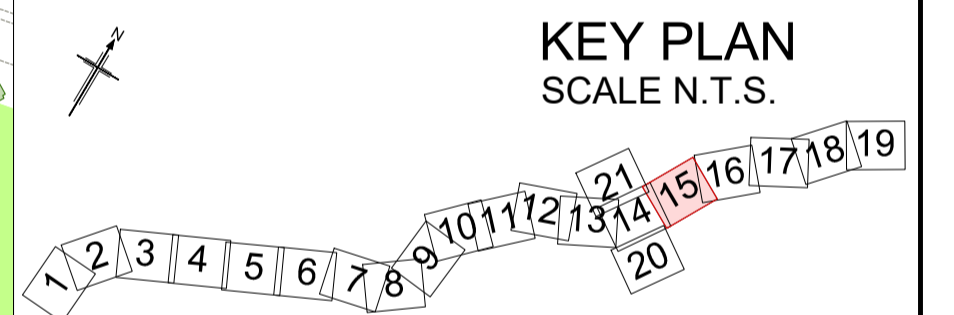

Rev	Rev. Date	Purpose of revision	Drawn	Checked	Rev'd	Appr'd
P01	01/08/22	FINAL FOR DCO SUBMISSION	AE	CC	CA	DT
P02	25/05/23	DCO CHANGE	AE	LH	RM	RM

Development Consent Order Number: TR010060  
Development Consent Order Drawing Number: TR010060/APP/2.9



Client: **national highways**

Project: **A12 CHELMSFORD TO A120 WIDENING SCHEME**

Drawing title: **GENERAL ARRANGEMENT  
CH. 32200 TO 33700  
SHEET 15 OF 21**

Regulation	REGULATION 8(1)(k)		
Purpose of issue	DCO EXAM		
State Code	Statutory Procedures and Powers		
Project Stage	PCF 4	Drawing status	
Scale at A1 (841x594mm)	1:2500	S4	
Jacobs No.	B36601D1	Rev	P02
Client no.	HE551497		

Drawing number: **HE551497 - JAC - LDC - SCHW - DR - C - 0035**

Originator: JAC, Volume: LDC, Location: SCHW, Type: DR, Role: C, Number: 0035

C:\working\jacobs\_uk\_highways\_ssa\elnourad\155545\HE551497-JAC-LDC-SCHW-DR-C-0035.dwg - 25/05/2023 13:51:02 - A1Frame - ElnourA

Reproduced by permission of Ordnance Survey on behalf of HMSO. © Crown copyright and database right 2020. All rights reserved. Ordnance Survey Licence number 100030649.

